

4 AND 2 DRUM HARDCOVER AND SPILLPALLET MODELS #4064 AND #4062 READ ALL ASSEMBLY INSTRUCTIONS BEFORE USE

THANK YOU FOR PURCHASING YOUR ENPAC HARDCOVER AND SPILLPALLET.
THESE EASY INSTALLATION INSTRUCTIONS WILL ASSURE YOU STABLE AND SPACE-EFFICIENT STORAGE.

RECOMMENDED TOOLS:

- Cordless Drill (12v or higher)
- Hex Head to Socket Drive transition
- $\frac{1}{2}$ " Socket

SHIPPED PRODUCT CONTAINS THE FOLLOWING:

- | <u>QTY</u> | <u>Part</u> |
|------------|---|
| (2) | SIDEWALLS (Part A) |
| (1) | UPPER SUPPORT BRACE (Part B) |
| (2) | LOWER SUPPORT LEG (Part C) |
| (4) | 5/16" x 5.5" LONG HEX HEAD LAG SCREW (ZINC PLATED) (Part D) |
| (6) | 5/16" x 1" FENDER WASHERS (ZINC PLATED) (Part E) |
| (2) | 5/16"-18 x 2" CAP SCREW (STAINLESS STEEL) (Part F) |
| (1) | SPILLPALLET WITH TWO LOCKING HASPS (Part G) |
| (1) | TAMBOUR DOOR WITH RIBS ON ONE END (Part H – SHOWN BELOW) |
| (1) | TAMBOUR DOOR WITHOUT RIBS ON THE END (Part I) |
| (2) | STANDARD BLACK GRATES, (1) FOR PART #4062 ONLY (Part J) |
| (1) | ASSEMBLY INSTRUCTION SHEET |

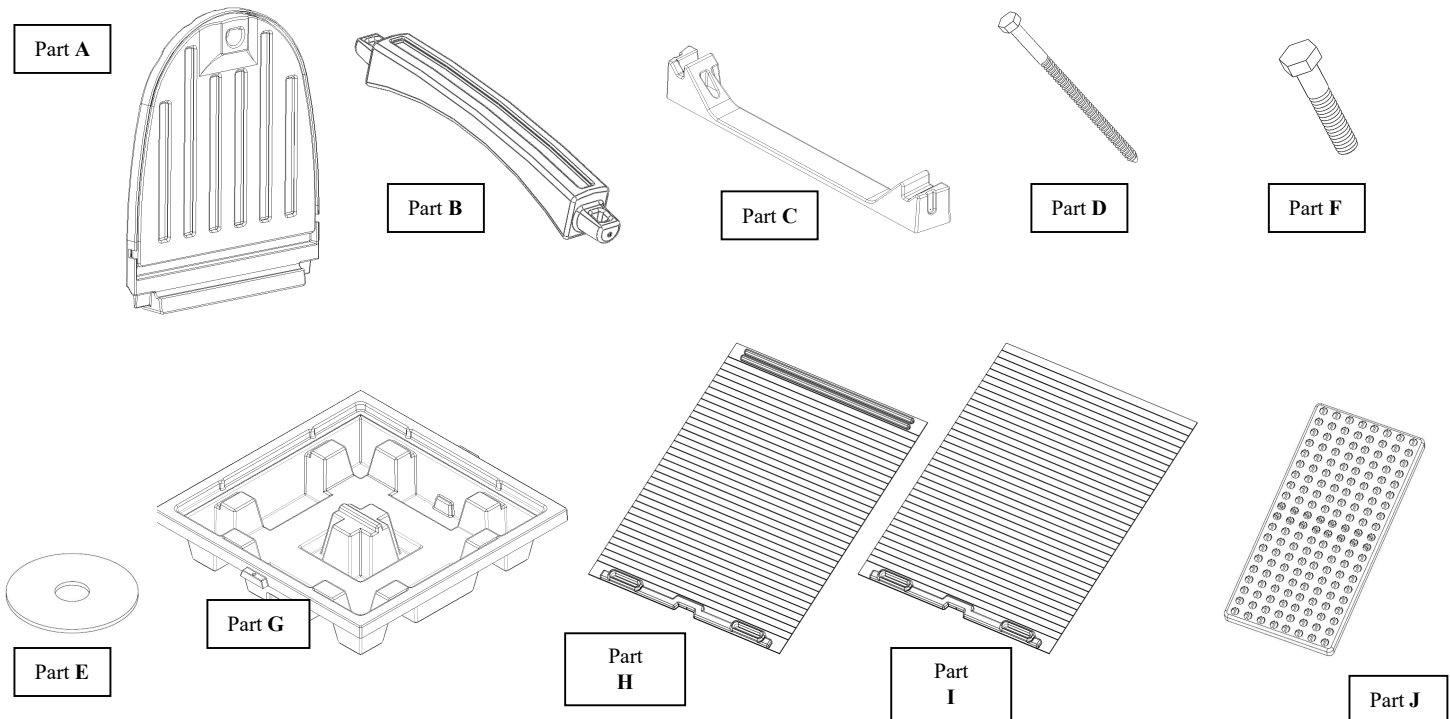

ENPAC, L.L.C. RECOMMENDS:

- ◆ **THIS PRODUCT SHOULD BE ASSEMBLED WITH TWO PEOPLE, BUT NOT REQUIRED.**
- ◆ **UPON RECEIVING THIS PRODUCT YOU SHOULD MAKE SURE THAT ALL PARTS ARE PRESENT PER THIS INSTRUCTION SHEET BEFORE ASSEMBLING.**
- ◆ **AFTER USING YOUR SPILLPALLET HARDCOVER, YOU SHOULD COAT THE TAMBOUR DOOR TRACKS WITH SILICONE (ANY OFF THE SHELF SILICONE WILL BE FINE) FROM TIME TO TIME TO ENSURE SMOOTH SLIDING DOORS.**

ASSEMBLY INSTRUCTIONS:

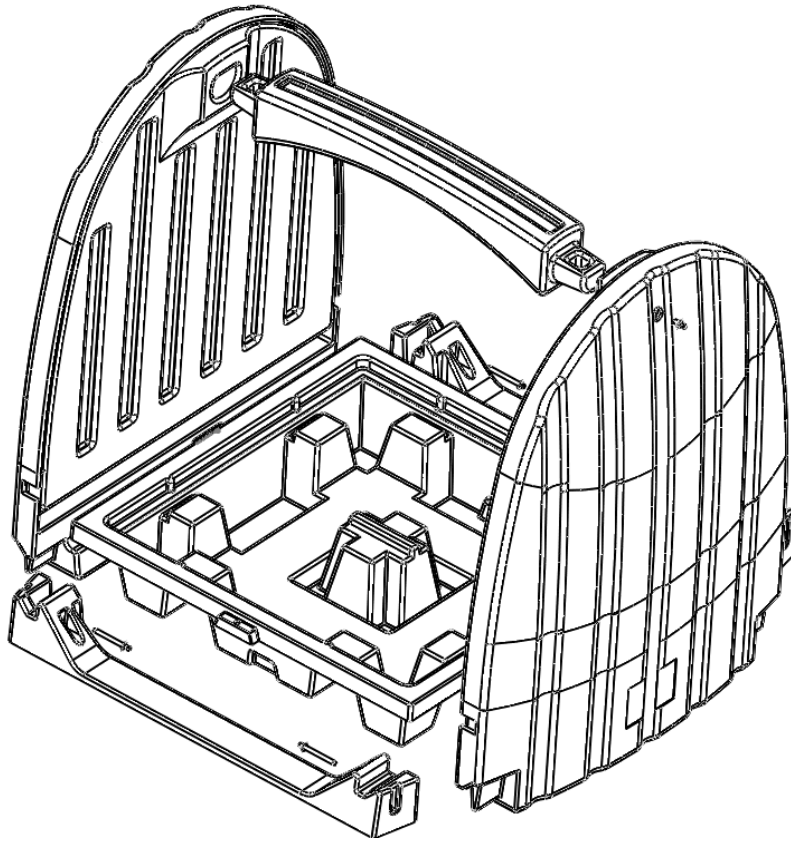

- 1) Stand Part (A), Hardcover Sidewall, upwards and slide it against Part G, the SpillPallet (set Parts J, the grates, onto the SpillPallet at this time too). Make sure the sides with molded in hasps on the SpillPallet are not touching the Hardcover Sidewall (See fig. 1)

FIG. 1

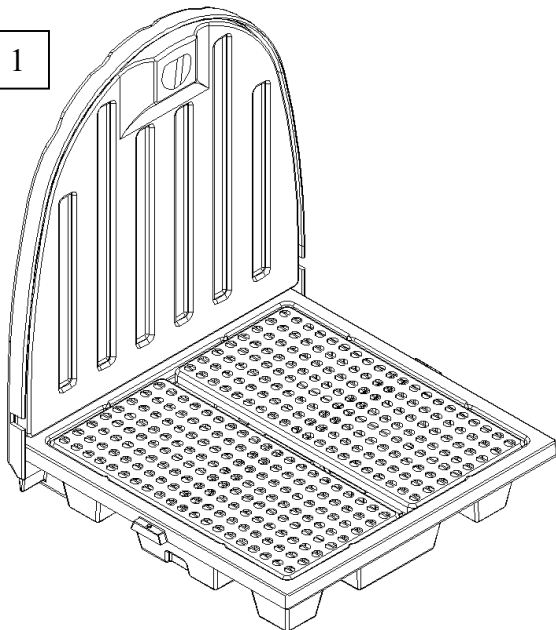
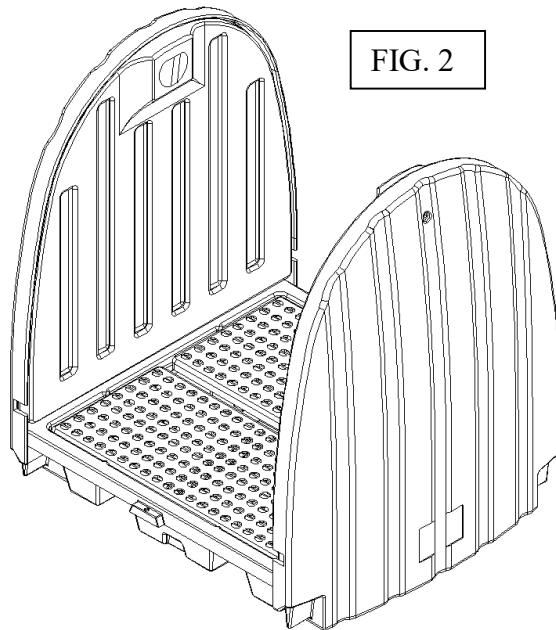

FIG. 2



- 2) Place the second Hardcover Sidewall on the opposite side of the SpillPallet. (See fig.2)

- 3) With Part (C), Lower Leg Brace, placed flat on ground in front of Parts (A), firmly press end pieces onto each corner of Part (A). (See fig. 3 & 4)

FIG. 3

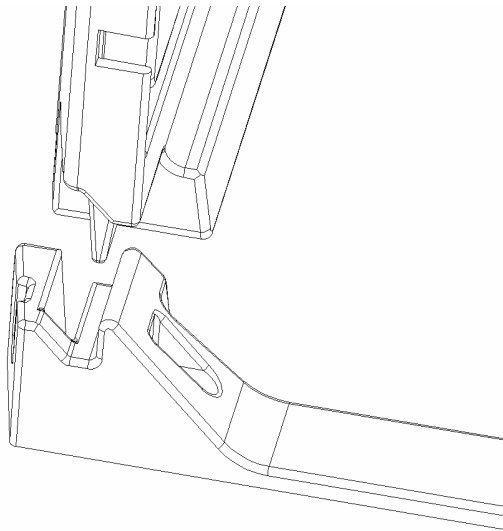
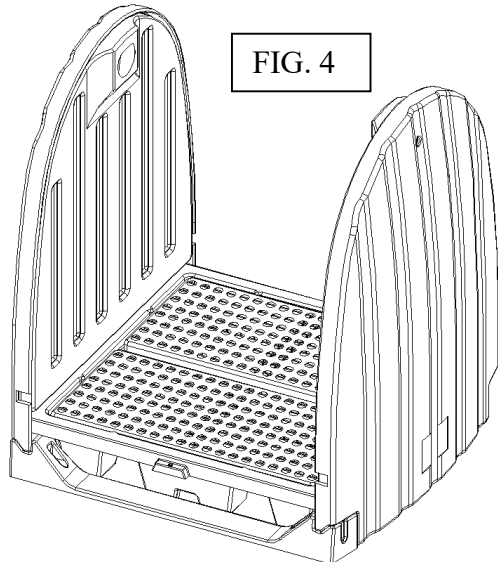
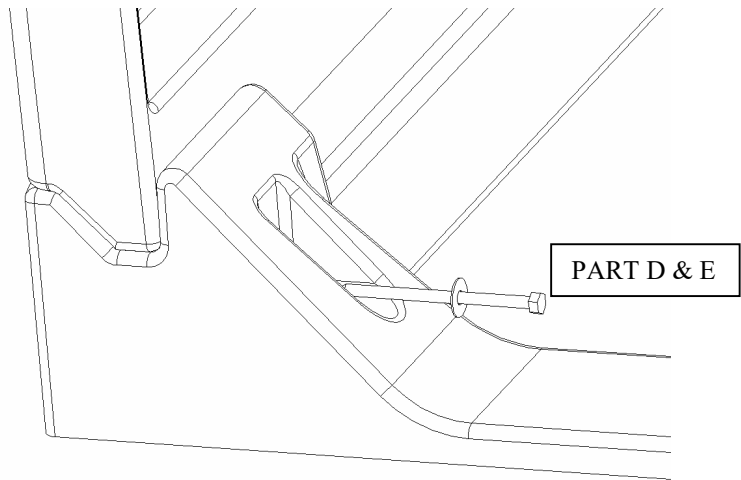

FIG. 4



- 4) Repeat step 3, with remaining Part (C).
5) Drive Part (D), 5/16" x 5 1/2" long lag screw with Part (E) fender washer, into Part (C) till secure as shown.
WARNING: DO NOT OVER TIGHTEN SCREW. (See fig. 5)

FIG. 5



- 6) Repeat step 5 for the three (3) remaining corners.
7) Next insert Part (B), top brace, into openings provided on Part (A), sidewall. (See fig. 6)

FIG. 6

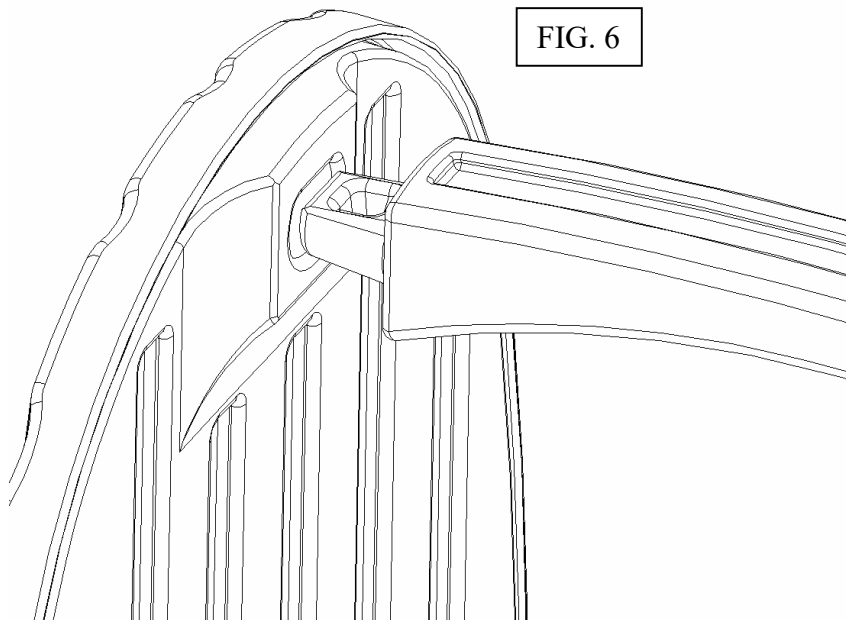

- 8) Fasten Part (B), top brace, with the 5/16"-18 x 2" cap screws (Part F) and the remaining fender washers (Part E), on each sidewall.
WARNING: DO NOT OVER TIGHTEN SCREW. (See fig. 7 & 7a)

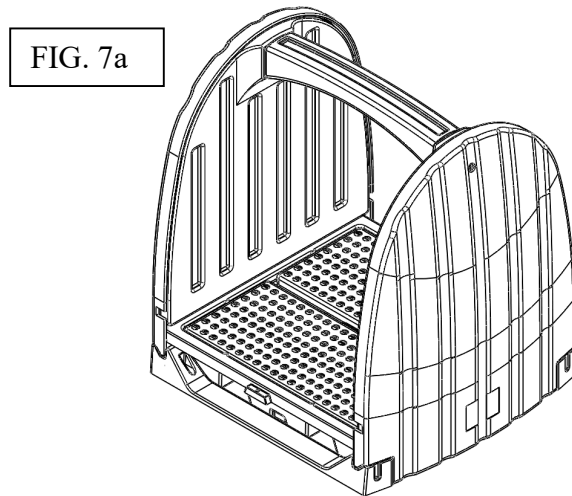
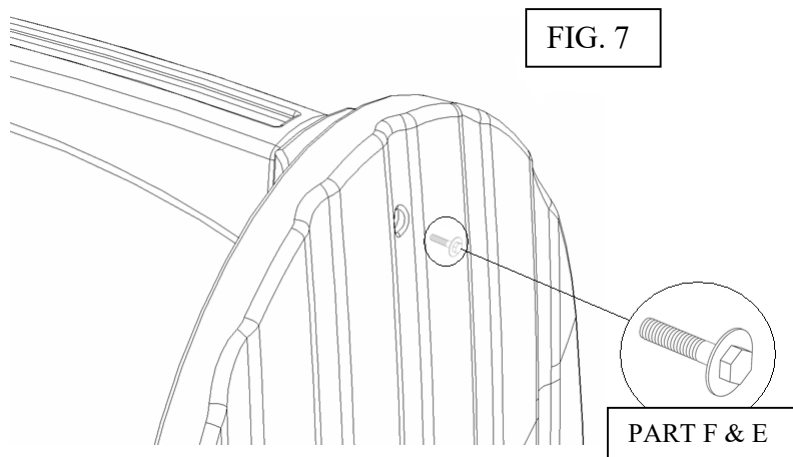

- 9) Place Part (I), tambour door without ribs on the end, down on the floor handles up, in front of the unit. (See fig. 8)

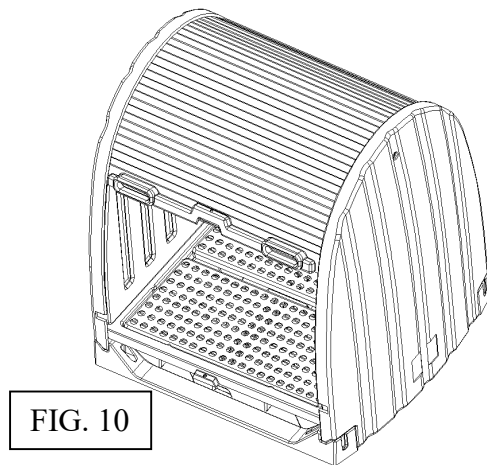
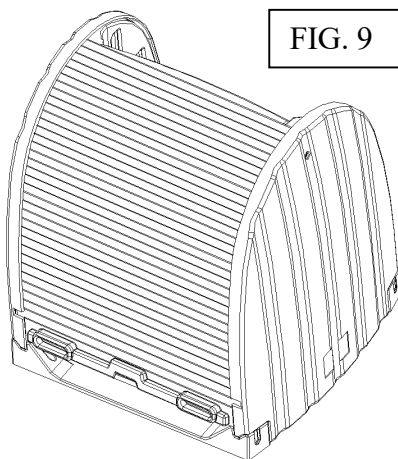
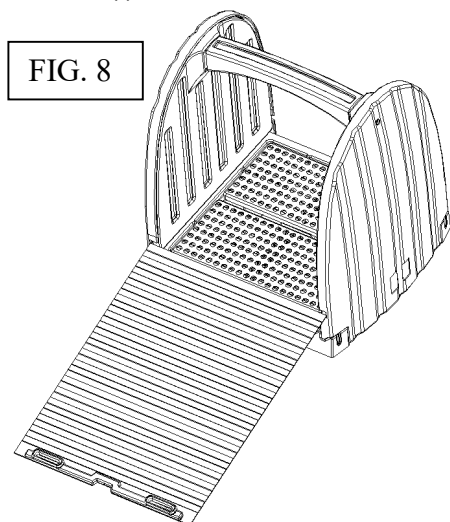

- 10) Ease Part (I), the tambour door without ribs on the end, into grooves provided and push door entirely in until it is securely inserted into the Hardcover sidewalls. (See fig. 9) It may help to stand on the pallet and pull the door into the grooves provided and pull door to figure 10. Leaving this door partially "open" might make the last step easier. (See fig. 10)

- 11) Repeat steps 9 and 10 with Part (H), tambour door with ribs and an aluminum extrusion on one end, from the opposite side of the Hardcover sidewalls, making sure Part (H) is over top of Part (I). (See fig. 11)

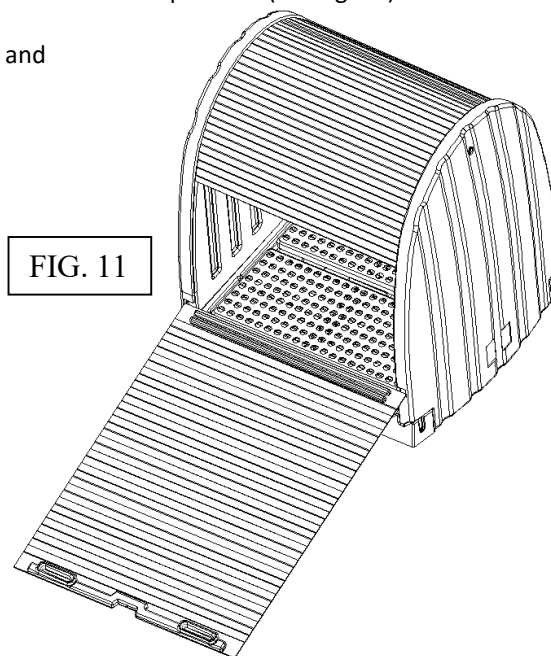

FOR MORE INFORMATION CONTACT ENPAC CUSTOMER SERVICE (800) 936-7229